

Housing 0.8 mm

0.8 Series

SPECIFICATIONS

Current Rating: 0.5 A, AC/DC

Voltage Rating: 30 V AC/DC

Temperature Range: -25°C ~ +85 °C

Contact Resistance: 20 mOhm max.

Insulator Resistance: 100 MOhm min.

Withstanding Voltage: AC 200 V / minute

Contact Material: Copper Alloy, Tin-plated

Material: PA46, UL 94V-0

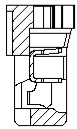
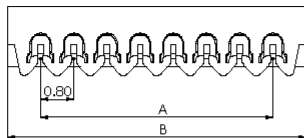
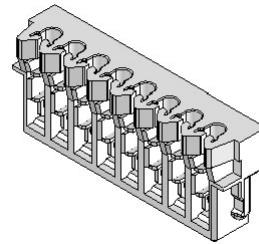

SECTION A-A

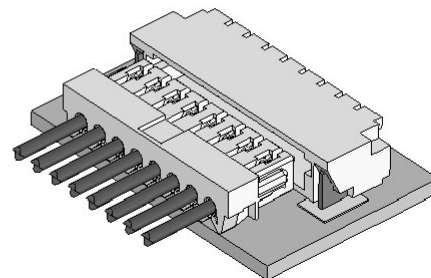
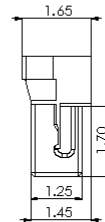
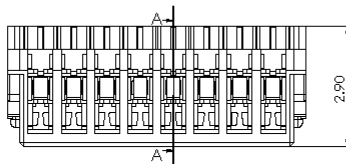

How to order

Unit: mm

Circuits	Dimension mm		Circuits	Dimension mm	
	A	B		A	B
2PIN	0.80	2.40	10PIN	7.20	8.80
4PIN	2.40	4.00	12PIN	8.80	10.40
6PIN	4.00	5.60	14PIN	10.40	12.00
7PIN	4.80	6.40	16PIN	12.00	13.60
8PIN	5.60	7.20	17PIN	12.80	14.40
9PIN	6.40	8.00	20PIN	15.20	16.80

CC0800 - H08(IDC) - XX
 T
 (02 TO 20 Contacts)